

# Barra tonda

Norme: EN 10088-3

Materiale: Aisi 304L EN 1.4307 - Aisi 316L EN 1.4304

cod. 005

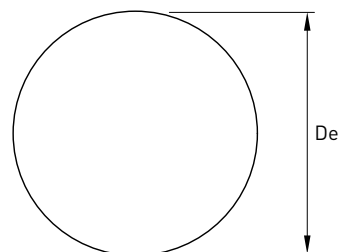
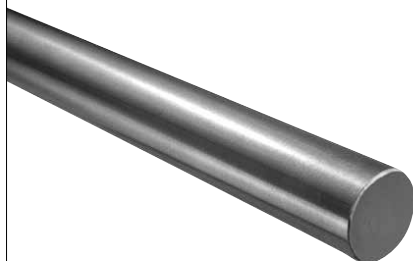

De mm	Stock	Peso kg/m
2	R	0,025
2,5	R	0,039
3	R	0,055
4	R	0,099
5	R	0,154
6	R	0,222
7	R	0,302
8	R	0,395
9	R	0,499
10	R	0,617
11	R	0,746
12	R	0,888
13	R	1,042
14	R	1,208
15	R	1,387
16	R	1,578
17	R	1,782
18	R	1,998
19	R	2,226
20	R	2,466
21	R	2,719
22	R	2,984
23	R	3,261
24	R	3,551
25	R	3,853
26	R	4,168
27	R	4,494
28	R	4,834
30	R	5,549

De mm	Stock	Peso kg/m
32	R	6,313
34	R	7,127
35	R	7,552
36	R	7,990
38	R	8,903
40	R	9,864
42	R	10,875
45	R	12,485
50	R	15,413
55	R	18,650
60	R	22,195
65	R	26,048
70	R	30,209
75	R	34,679
80	R	39,457
85	R	44,544
90	R	49,938
100	R	61,652