

Caps

Norme: ASME B16.9 - ASTM403

Materiale: Aisi 304L EN 1.4307 - Aisi 316L EN 1.4404

cod. 312

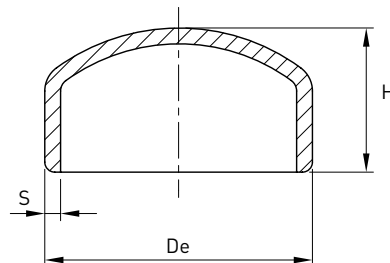

De x Spessore (S) mm	Dimensioni	H mm	Stock	Peso kg
21,34 x 2,11	1/2" SCH 10S	25	D	0,04
21,34 x 2,77	1/2" SCH 40S	25	D	0,05
21,34 x 3,73	1/2" SCH 80S	25	R	0,06
26,67 x 2,11	3/4" SCH 10S	25	D	0,06
26,67 x 2,87	3/4" SCH 40S	25	D	0,07
26,67 x 3,91	3/4" SCH 80S	25	R	0,08
33,40 x 2,77	1" SCH 10S	38	D	0,09
33,40 x 3,38	1" SCH 40S	38	D	0,13
33,40 x 4,55	1" SCH 80S	38	R	0,13
42,16 x 2,77	1.1/4" SCH 10S	38	D	0,13
42,16 x 3,56	1.1/4" SCH 40S	38	D	0,17
42,16 x 4,85	1.1/4" SCH 80S	38	R	0,18
48,26 x 2,77	1.1/2" SCH 10S	38	D	0,14
48,26 x 3,68	1.1/2" SCH 40S	38	D	0,23
48,26 x 5,08	1.1/2" SCH 80S	38	R	0,24
60,33 x 2,77	2" SCH 10S	38	D	0,19
60,33 x 3,91	2" SCH 40S	38	D	0,26
60,33 x 5,54	2" SCH 80S	38	R	0,35
73,03 x 3,05	2.1/2" SCH 10S	38	D	0,25
73,03 x 5,16	2.1/2" SCH 40S	38	D	0,45
73,03 x 7,01	2.1/2" SCH 80S	38	R	0,51
88,90 x 3,05	3" SCH 10S	51	D	0,40
88,90 x 5,49	3" SCH 40S	51	D	0,71
88,90 x 7,62	3" SCH 80S	51	R	0,85
114,30 x 3,05	4" SCH 10S	64	D	0,65
114,30 x 6,02	4" SCH 40S	64	D	1,22
114,30 x 8,56	4" SCH 80S	64	R	1,61
141,30 x 3,40	5" SCH 10S	76	D	1,02
141,30 x 6,55	5" SCH 40S	76	D	1,91
168,28 x 3,40	6" SCH 10S	89	D	1,36
168,28 x 7,11	6" SCH 40S	89	D	3,23
168,28 x 10,97	6" SCH 80S	89	R	4,54
219,08 x 3,76	8" SCH 10S	102	D	2,49
219,08 x 8,18	8" SCH 40S	102	D	5,67
219,08 x 12,70	8" SCH 80S	102	R	7,80
273,05 x 4,19	10" SCH 10S	127	R	4,90
273,05 x 9,27	10" SCH 40S	127	R	9,21
273,05 x 12,70	10" SCH 80S	127	R	13,10
323,85 x 4,57	12" SCH 10S	152	R	6,53
323,85 x 9,53	12" SCH 40S	152	R	13,06
323,85 x 12,70	12" SCH 80S	152	R	17,30