

Tee SS

Norme: ASME B16.9 - ASTM403

Materiale: Aisi 304L EN 1.4307 - Aisi 316L EN 1.4404

cod. 322

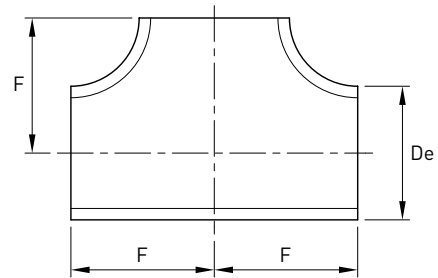

De x Spessore mm	Dimensioni	F mm	Stock	Peso kg
21,34 x 2,11	1/2" SCH 10S	25	D	0,07
21,34 x 2,77	1/2" SCH 40S	25	D	0,08
21,34 x 3,73	1/2" SCH 80S	25	R	0,14
26,67 x 2,11	3/4" SCH 10S	29	D	0,09
26,67 x 2,87	3/4" SCH 40S	29	D	0,11
26,67 x 3,91	3/4" SCH 80S	29	R	0,20
33,40 x 2,77	1" SCH 10S	38	D	0,20
33,40 x 3,38	1" SCH 40S	38	D	0,24
33,40 x 4,55	1" SCH 80S	38	R	0,39
42,16 x 2,77	1.1/4" SCH 10S	48	D	0,33
42,16 x 3,56	1.1/4" SCH 40S	48	D	0,41
42,16 x 4,85	1.1/4" SCH 80S	48	R	0,54
48,26 x 2,77	1.1/2" SCH 10S	57	D	0,46
48,26 x 3,68	1.1/2" SCH 40S	57	D	0,60
48,26 x 5,08	1.1/2" SCH 80S	57	R	1,02
60,33 x 2,77	2" SCH 10S	64	D	0,63
60,33 x 3,91	2" SCH 40S	64	D	0,87
60,33 x 5,54	2" SCH 80S	64	R	1,60
73,03 x 3,05	2.1/2" SCH 10S	76	D	1,10
73,03 x 5,16	2.1/2" SCH 40S	76	D	1,70
73,03 x 7,01	2.1/2" SCH 80S	76	R	3,63
88,90 x 3,05	3" SCH 10S	86	D	1,37
88,90 x 5,49	3" SCH 40S	86	D	1,90
88,90 x 7,62	3" SCH 80S	86	R	4,45
114,30 x 3,05	4" SCH 10S	105	D	2,15
114,30 x 6,02	4" SCH 40S	105	D	4,13
114,30 x 8,56	4" SCH 80S	105	R	7,70
141,30 x 3,40	5" SCH 10S	124	D	3,48
141,30 x 6,55	5" SCH 40S	124	D	6,55
168,28 x 3,40	6" SCH 10S	143	D	4,76
168,28 x 7,11	6" SCH 40S	143	D	9,73
168,28 x 10,97	6" SCH 80S	143	R	13,61
219,08 x 3,76	8" SCH 10S	178	D	8,46
219,08 x 8,18	8" SCH 40S	178	D	18,00
219,08 x 12,70	8" SCH 80S	178	R	27,40
273,05 x 4,19	10" SCH 10S	216	D	14,20
273,05 x 9,27	10" SCH 40S	216	D	30,60
323,85 x 4,57	12" SCH 10S	254	D	21,60
323,85 x 9,53	12" SCH 40S	254	D	44,30
355,60 x 4,78	14" SCH 10S	279	D	48,53
355,60 x 9,53	14" SCH 40S	279	D	79,38
406,40 x 4,77	16" SCH 10S	305	D	58,90
406,40 x 9,53	16" SCH 40S	305	D	99,70