

# Prolunga M/F microfusa

Norme: ISO 7/1 GAS Conico X ISO 228/1 GAS Cilindrico  
Materiale: Aisi 316 EN 1.4401

cod. 146

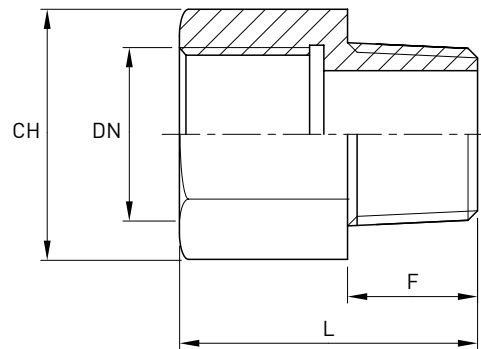

| DN | Ø GAS<br>inch | L<br>mm | F<br>mm | CH<br>mm | Stock |
|----|---------------|---------|---------|----------|-------|
| 8  | 1/4"          | 28,5    | 12      | 17       | R     |
| 10 | 3/8"          | 31      | 12,3    | 21       | R     |
| 15 | 1/2"          | 37,5    | 14,6    | 26       | R     |
| 20 | 3/4"          | 41      | 17,5    | 32       | R     |
| 25 | 1"            | 46      | 20,1    | 38       | R     |
| 32 | 1 1/4"        | 49      | 22      | 50       | R     |
| 40 | 1 1/2"        | 51      | 23,5    | 54       | R     |
| 50 | 2"            | 57      | 26,5    | 68       | R     |