

# Bocchettone M/F serie 3000 NPT (M/F union)

Norme: ANSI B16.11 - ASME B1.20.1

Materiale: Aisi 316L EN 1.4404

cod. 471

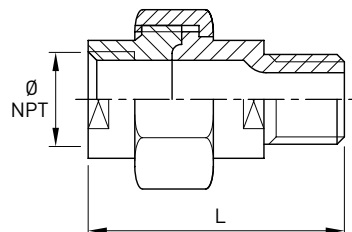

DN	Ø NPT inch	D mm	L mm	Stock
15	1/2"	21,34	75	R
20	3/4"	26,7	80	R
25	1"	33,4	90	R
32	1 1/4"	42,16	98	R
40	1 1/2"	48,26	100	R
50	2"	60,3	120	R