

# Tappo maschio esagonale serie 3000 NPT (hexagonal plug)

Norme: ANSI B16.11 - ASME B1.20.1

Materiale: Aisi 316L EN 1.4404

cod. 482

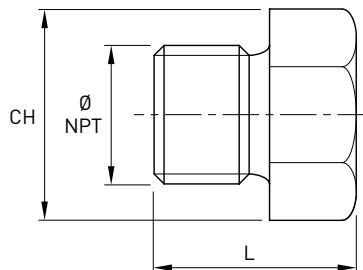

DN	Ø NPT inch	L mm	CH mm	Stock
15	1/2"	22	22	R
20	3/4"	26	27	R
25	1"	29	36	R
40	1"1/2	37	50	R
50	2"	40	65	R