

Tappo maschio esagonale serie 3000 NPT (hexagonal plug)

Norme: ANSI B16.11 - ASME B1.20.1

Materiale: Aisi 316L EN 1.4404

cod. 482

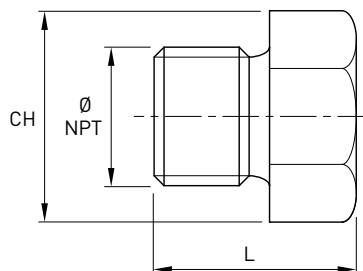

DN	Ø NPT inch	L mm	CH mm	Stock
15	1/2"	28	22	D
20	3/4"	31	27	D
25	1"	35	35	D
40	1"1/2	43	51	D
50	2"	47	64	D