

# Guarnizione per raccordo completo a saldare

Norme: DIN 11852

Materiale: NBR

cod. 526

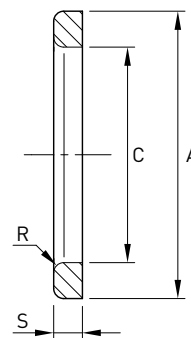

| DN  | A<br>mm | C<br>mm | R<br>mm | S<br>mm | Stock |
|-----|---------|---------|---------|---------|-------|
| 15  | 26      | 18      | 2,3     | 4       | D     |
| 20  | 33      | 23      | 2,8     | 4       | D     |
| 25  | 40      | 30      | 2,8     | 4       | D     |
| 32  | 46      | 36      | 2,8     | 5       | D     |
| 40  | 52      | 42      | 2,8     | 5       | D     |
| 50  | 64      | 54      | 2,8     | 5       | D     |
| 65  | 81      | 71      | 2,8     | 5       | D     |
| 80  | 95      | 85      | 2,8     | 5       | D     |
| 100 | 114     | 104     | 2,8     | 5       | D     |
| 125 | 142     | 130     | 3,5     | 7       | D     |
| 150 | 167     | 155     | 3,5     | 7       | D     |